

# ASSEMBLY INSTRUCTIONS

MODEL #

CM3752PT-5PK

Questions?

GIVE US A CALL: 1-888-980-5122  
MON – FRI 8:30AM – 5:30PM (PST)

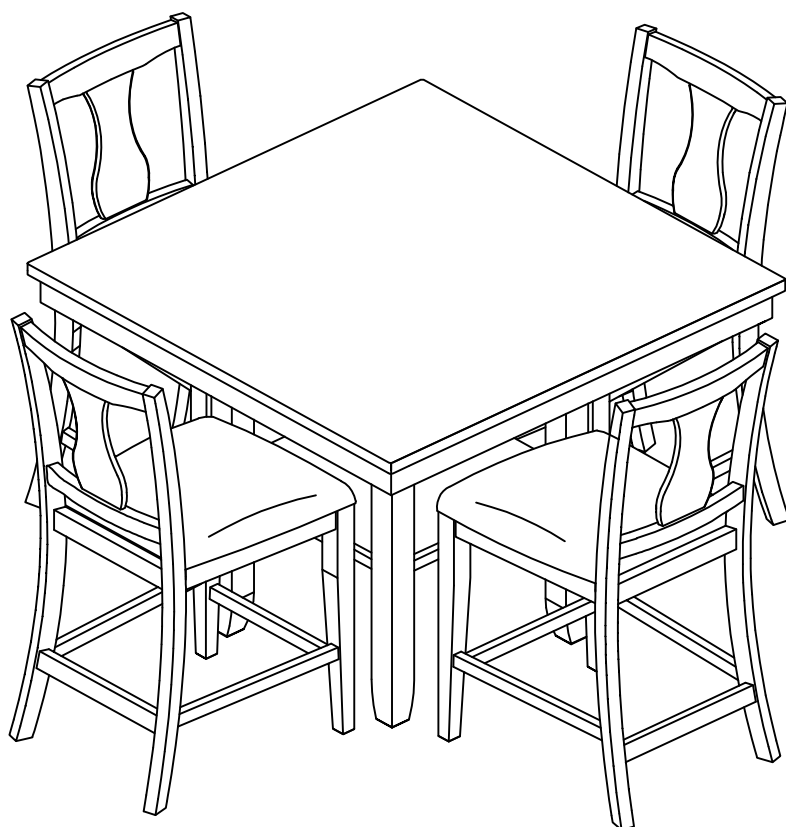

## TOOLS REQUIRED



Allen Wrench

(Included)



Phillips  
Screwdriver

(Not Included)

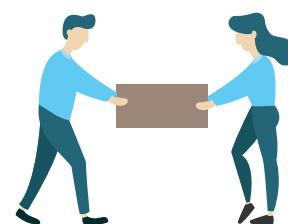

**2 - People  
Recommended**

## ASSEMBLY RATING



EASY —————> DIFFICULT

The Assembly Rating is a 5-point system showing the level of effort needed to assemble a specific product.



FOA Intro

Thank you for your purchase!

We hope you enjoy this new addition to your home for many years to come.

Our commitment to providing quality products does not simply end when you purchase our product. We fully stand behind our products from start to finish. Our customer service department is available Monday – Friday 8:30 AM – 5:30 PM Pacific and can help with assembly questions as well as, if necessary, replacing damaged or missing parts. To help expedite our service, please have these assembly instructions readily available, along with your order receipt.



**Consumer Hotline**  
Toll-Free 1-888-980-5122



**WEBSITE**  
[www.foagroup.com](http://www.foagroup.com)



**Monday to Friday**  
8:30AM- 5:30PM (PST)



**E-MAIL**  
[cs.ec@foagroup.com](mailto:cs.ec@foagroup.com)



foagroup



FurnitureOfAmerica



## CHECK BEFORE STARTING

☐

### Are you missing anything?

Double-check all parts, hardware and accessories listed on Page 6 are accounted for.

☐

### Check out our Quick Tips!

We recommend reviewing the pre-assembly handouts. Even experts need a refresher now and then!

☐

### Should we send any replacements?

Are there any irregularities or flaws in the parts? We can send replacements!

☐

### Prep Time!

Please review the assembly instructions and all diagrams prior to assembling. Arrange parts as recommended on Page 7 and group identical hardware together to make assembling easier.

# PRE ASSEMBLY INTRODUCTION

We understand building ready-to-assemble furniture can be a challenging experience for some. To help avoid confusion, we have provided some helpful tips that may speed up the process.

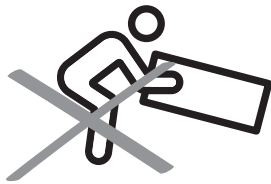

## Teamwork

ALWAYS have at least two people to help with transporting and assembling the product to avoid potential injury and/or damage.

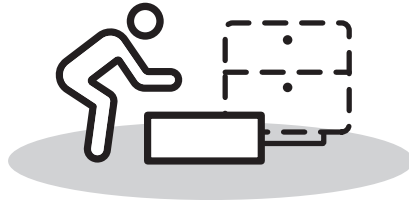
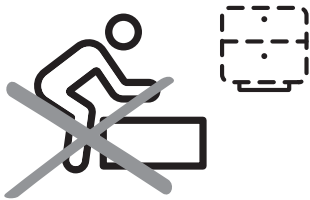

## Suitable Location

Assembling near the area of the intended location is highly recommended.



## Sufficient Space

Make sure you have enough space to move around during the assembly.

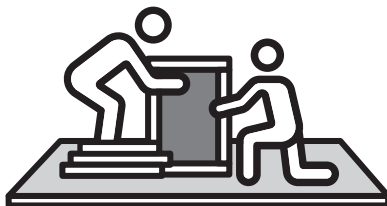

## Avoid Scratches

Use cardboard, blankets or a carpeted area while assembling furniture to prevent scratches.

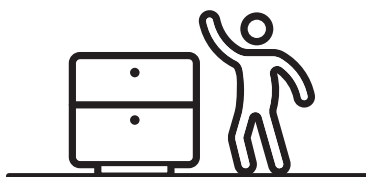
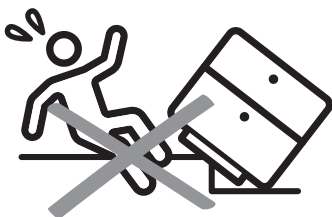

## Flat Surface

Make sure the furniture rests on a flat and level surface with each leg evenly touching the floor.

# ASSEMBLY AND CARE ADVICE



**FAILURE TO FOLLOW THE GUIDELINES BELOW MAY  
RESULT IN INJURY AND/OR PROPERTY DAMAGE.**



Position each part correctly  
and insert screws or bolts into  
their respective holes.

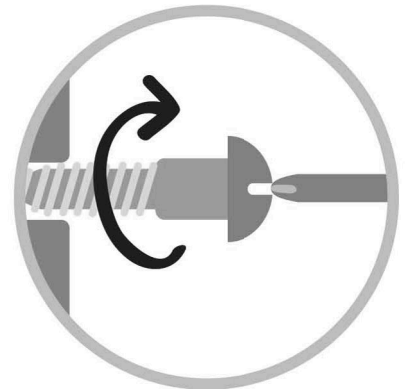

Turn clockwise to tighten and  
only tighten when step is  
completed or when instructed  
to do so.



Save the instructions and store  
any supplied tools for later  
maintenance.

Use the appropriate hand tools  
or power tools for assembly.  
Select steps, such as tightening  
screws and/or bolts, may require  
hand tools to avoid causing  
damage during assembly.



After two weeks, check and  
tighten any loose hardware and  
repeat again every six months  
thereafter.

**IT IS THE USER'S RESPONSIBILITY TO MAINTAIN THE FURNITURE. THE HARDWARE MAY LOOSEN OVER TIME AND MAY CAUSE THE FURNITURE TO BE WOBBLY AND UNABLE TO SUPPORT ITS INTENDED WEIGHT CAPACITY. THIS MAY LEAD TO COLLAPSE AND MAY CAUSE SERIOUS INJURY.**

## 5PC. COUNTER HT. TABLE SET-TABLE

CM3752PT-5PK



- Please keep instructions for future reference.
- Check the quantity and irregularity of parts and hardware before you start.

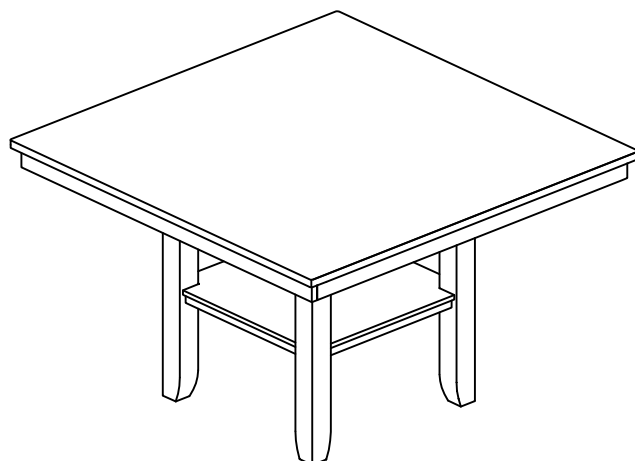

### PARTS

#1 1pc

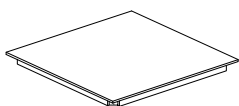

Table Top

#2 4pcs

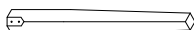

Table leg

#3 1pc

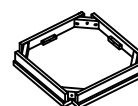

Table Shelf

### HARDWARE

#A 12pcs



Bolt  $\phi 5/16$ "X2-1/2"

#B 12pcs



Spring Washer  $\phi 5/16$ "

#C 12pcs



Flat Washer  $\phi 5/16$ "

#D 1pc

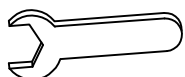

Wrench 12mm

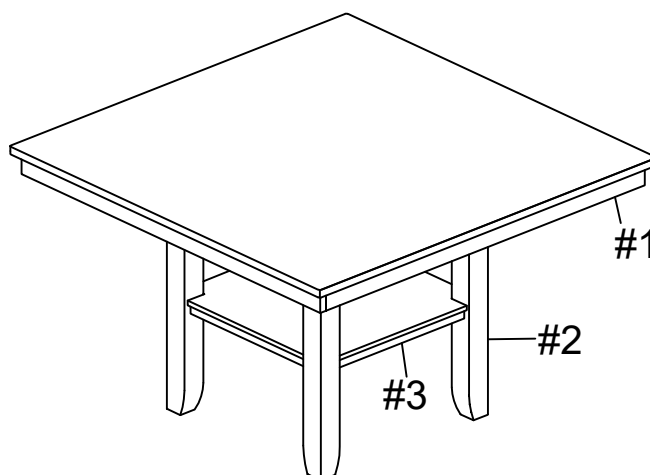

# ASSEMBLY INSTRUCTIONS

## 1

1) Prepare 8 bolts assembly by Spring Washer (#B), then flat washer (#C) onto bolts (#A). Align legs (#2) to the holes of the table top (#1). Secure by using bolts (#A), but do not fully tighten.

Part #1 X 1pc  
Part #2 X 4pcs  
Hardware #A X 8pcs  
Hardware #B X 8pcs  
Hardware #C X 8pcs

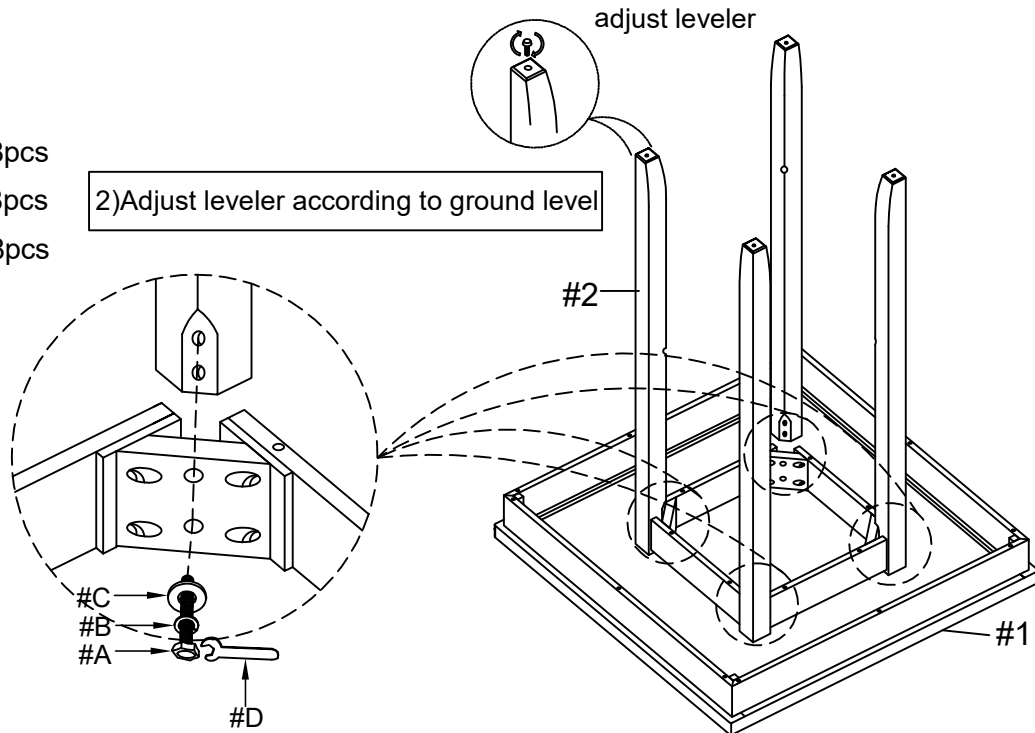

## 2

Hardware #A X 4pcs  
Hardware #B X 4pcs  
Hardware #C X 4pcs

1) Prepare 4 bolts assembly by Spring Washer (#B), then flat washer (#C) onto bolts (#A). Secure shelf (#3) by using bolts (#A). Fully tighten all bolts.

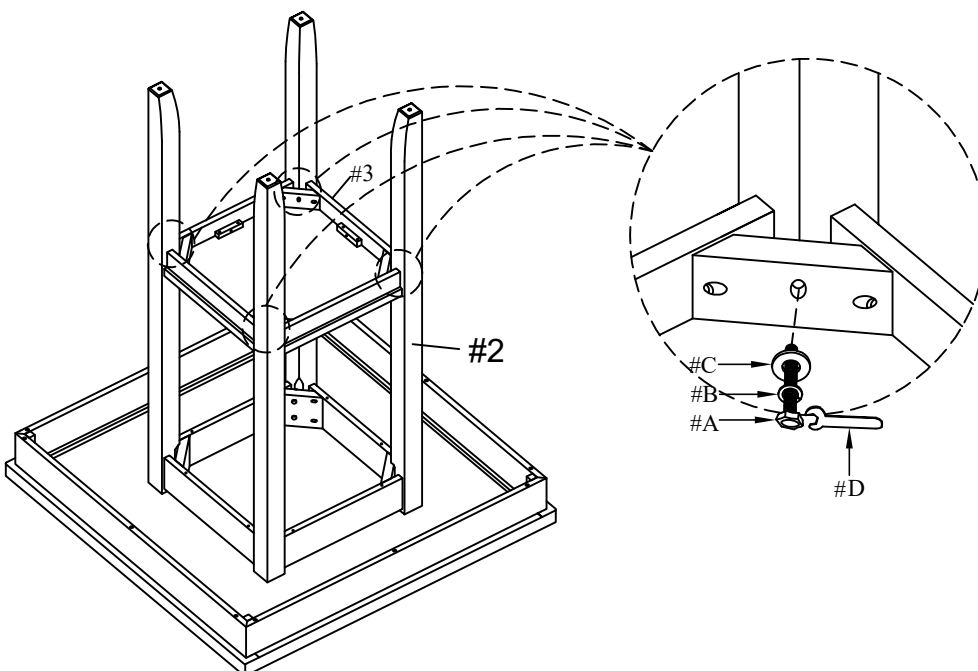

## ASSEMBLY COMPLETED



Please ensure the furniture rests on even and flat surface. If the product wobbles or feels loose, double-check all bolts and/or screws are properly tightened and secured.



### Keep this handy!

Please retain this instruction manual and any order-related information for future reference.



### Lift, don't drag!

To avoid damage to product please always LIFT the product when transporting at adjusting the placement.

# 5PC. COUNTER HT. TABLE SET-CHAIR

CM3752PT-5PK

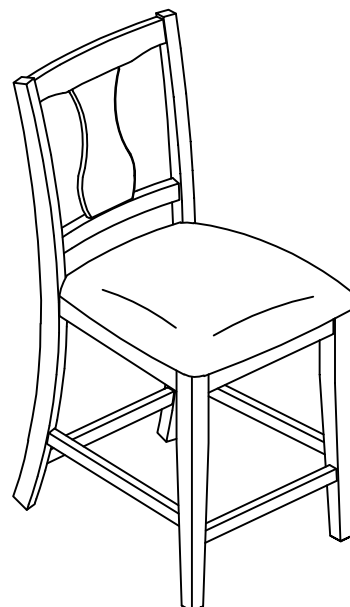
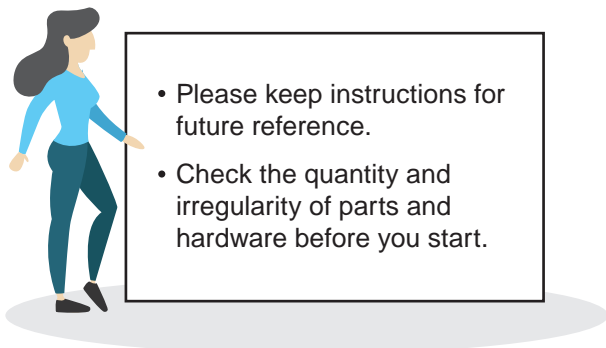

## PARTS

#1 1pc x4

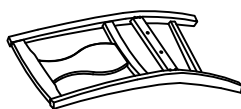

Chair back

#2 1pc x4

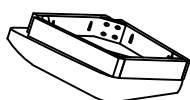

Seat

#3 2pcs x4

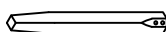

Front leg

#4 2pcs x4



Side stretcher L/R

#5 1pc x4



Front stretcher

## HARDWARE

#A 4pcs X4



Bolt  $\phi 1/4"$ X3"

#B 4pcs X4

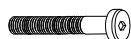

Bolt  $\phi 1/4"$ X2-1/2"

#C 2pcs X4



Bolt  $\phi 1/4"$ X1-1/2"

#D 10pcs x 4



Spring Washer  $\phi 1/4"$

#E 10pcs x 4



Flat Washer  $\phi 1/4"$

#F 1pc x4



Allen Wrench M4

#G 6pcs x6

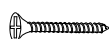

screws  
 $\phi 8$ X1-3/4"

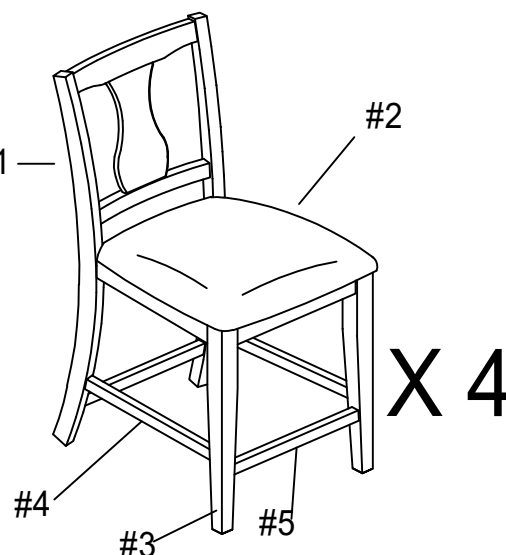

# ASSEMBLY INSTRUCTIONS

## 1

Prepare 2 bolts assembly by Spring Washer (#D), then flat washer (#E) onto bolts (#C). Align seat frame (#3) to the chair back (#1), then secure by using bolts (#C). Do not fully tighten bolts (#C).

Part #1 X 1pc

Part #3 X 1pc

Hardware #C X 2pcs

Hardware #D X 2pcs

Hardware #E X 2pcs

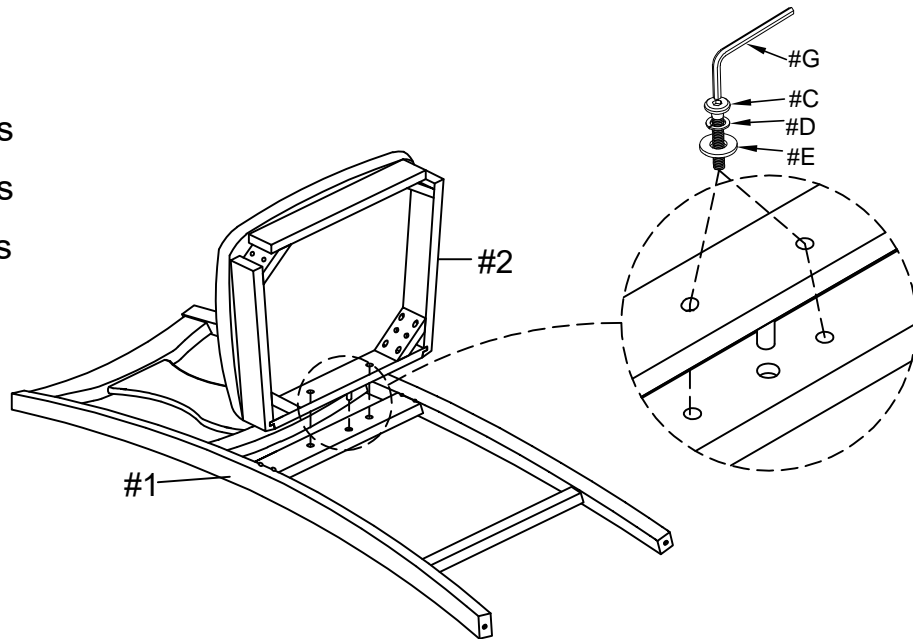

## 2

Prepare 4 bolts assembly by Spring Washer (#D), then flat washer (#E) onto bolts (#A). Secure cornerholes holes of seat frame (#3) to chair back (#1) by using bolts (#A). Fully tighten bolts (#A.C).

Hardware #A X 4pcs

Hardware #D X 4pcs

Hardware #E X 4pcs

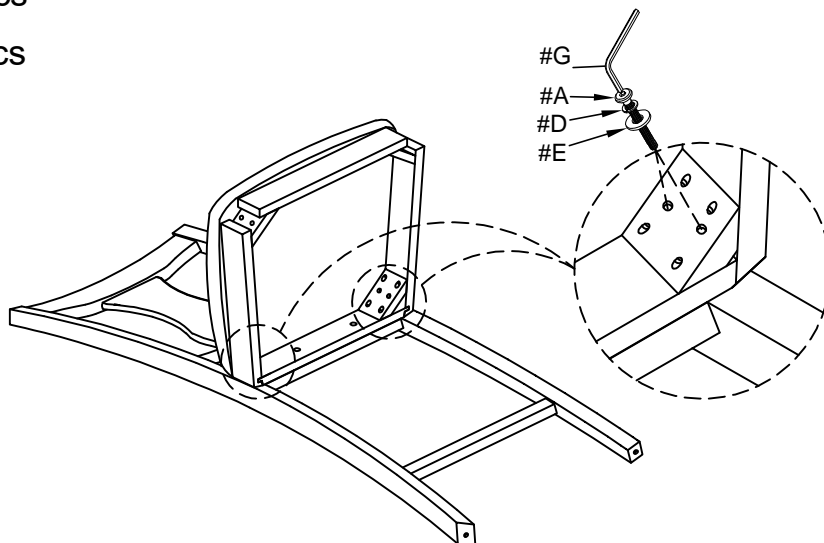



# ASSEMBLY INSTRUCTIONS

## 3

Prepare 4 bolts assembly by Spring Washer (#D), then flat washer (#E) onto bolts (#B). Align front legs (#4) to the holes of the chair frame (#3). Secure by using bolts (#B)

Part (#4) X 2pcs  
Hardware (#B) X 4pcs  
Hardware (#D) X 4pcs  
Hardware (#E) X 4pcs

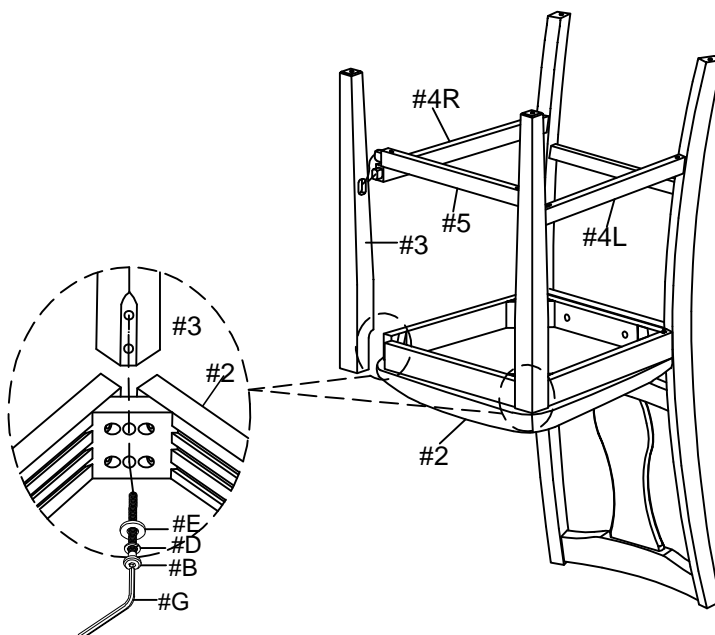

## 4

Part (#4) X 2pcs  
Part (#5) X 1pc  
Hardware (#G) X 6pcs

Prepare 6 screws (#G) assemble the seat cushion (#3) then tighten the screws

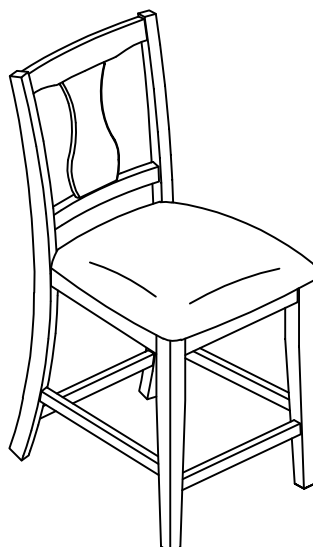
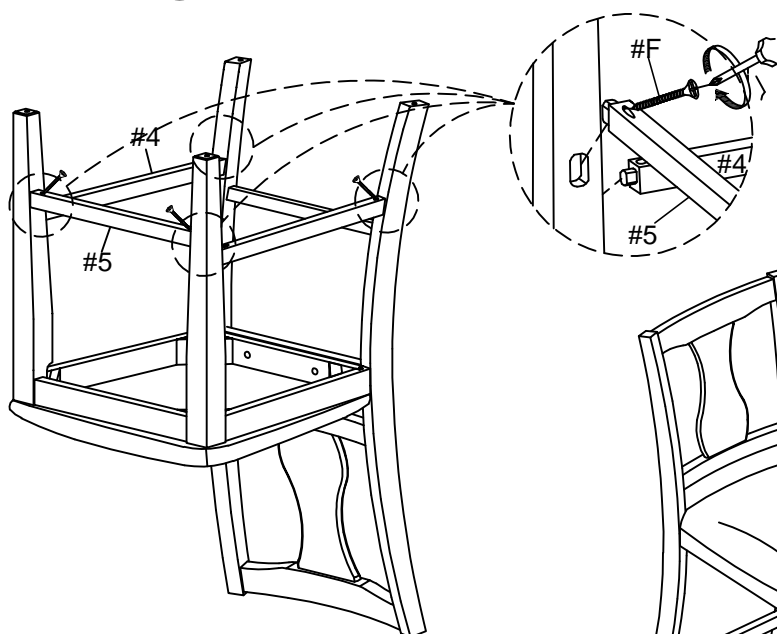

## ASSEMBLY COMPLETED



Please ensure the furniture rests on even and flat surface. If the product wobbles or feels loose, double-check all bolts and/or screws are properly tightened and secured.



### Keep this handy!

Please retain this instruction manual and any order-related information for future reference.



### Lift, don't drag!

To avoid damage to product please always LIFT the product when transporting at adjusting the placement.