

ASSEMBLY INSTRUCTIONS

MODEL #

CM3609PT-5PK

Questions?

GIVE US CALL: 1-888-980-5122
MON-FRI 8:30AM - 5:30PM (PST)

TOOLS REQUIRED



Allen Wrench

(Included)



Phillips
Screwdriver

(Not Included)

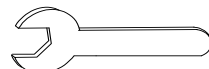

Wrench 13mm

(Included)



2 - People
Recommended

ASSEMBLY RATING



EASY —————> DIFFICULT

The Assembly Rating is a 5-point system showing the level of effort needed to assemble a specific product.

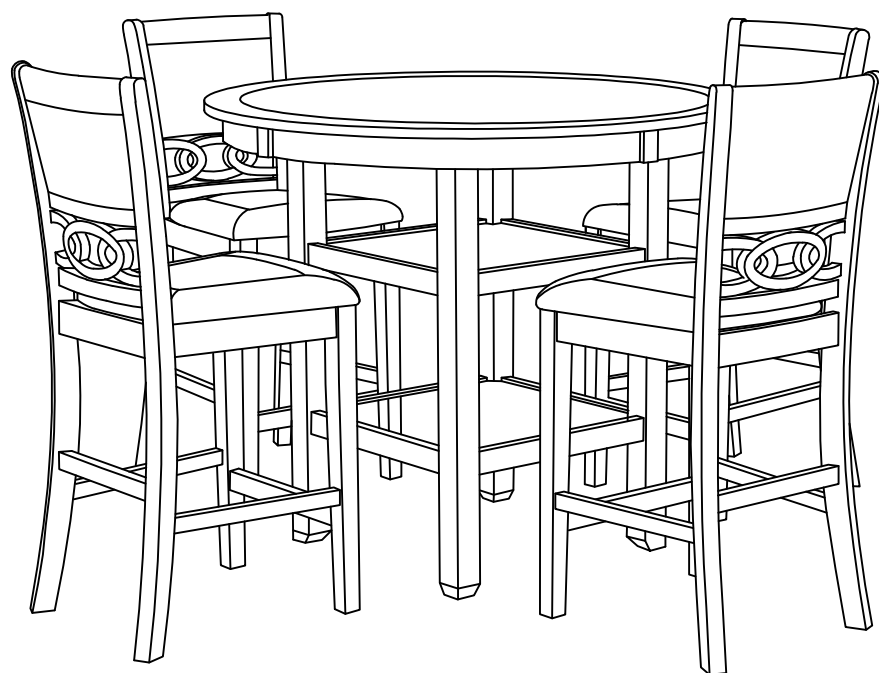



FOA Intro

Thank you for your purchase!

We hope you enjoy this new addition to your home for many years to come.

Our commitment to providing quality products does not simply end when you purchase our product. We fully stand behind our products from start to finish. Our customer service department is available Monday – Friday 8:30 AM – 5:30 PM Pacific and can help with assembly questions as well as, if necessary, replacing damaged or missing parts. To help expedite our service, please have these assembly instructions readily available, along with your order receipt.



Consumer Hotline
Toll-Free 1-888-980-5122



WEBSITE
www.foagroup.com



Monday to Friday
8:30AM- 5:30PM (PST)



E-MAIL
cs.ec@foagroup.com



foagroup



FurnitureOfAmerica



CHECK BEFORE STARTING

☐

Are you missing anything?

Double-check all parts, hardware and accessories listed on Page 6 are accounted for.

☐

Check out our Quick Tips!

We recommend reviewing the pre-assembly handouts. Even experts need a refresher now and then!

☐

Should we send any replacements?

Are there any irregularities or flaws in the parts? We can send replacements!

☐

Prep Time!

Please review the assembly instructions and all diagrams prior to assembling. Arrange parts as recommended on Page 7 and group identical hardware together to make assembling easier.

PRE ASSEMBLY INTRODUCTION

We understand building ready-to-assemble furniture can be a challenging experience for some. To help avoid confusion, we have provided some helpful tips that may speed up the process.



Teamwork

ALWAYS have at least two people to help with transporting and assembling the product to avoid potential injury and/or damage.



Suitable Location

Assembling near the area of the intended location is highly recommended.



Sufficient Space

Make sure you have enough space to move around during the assembly.



Avoid Scratches

Use cardboard, blankets or a carpeted area while assembling furniture to prevent scratches.



Flat Surface

Make sure the furniture rests on a flat and level surface with each leg evenly touching the floor.

ASSEMBLY AND CARE ADVICE



**FAILURE TO FOLLOW THE GUIDELINES BELOW MAY
RESULT IN INJURY AND/OR PROPERTY DAMAGE.**



Position each part correctly
and insert screws or bolts into
their respective holes.



Turn clockwise to tighten and
only tighten when step is
completed or when instructed
to do so.



Save the instructions and store
any supplied tools for later
maintenance.

Use the appropriate hand tools
or power tools for assembly.
Select steps, such as tightening
screws and/or bolts, may require
hand tools to avoid causing
damage during assembly.



After two weeks, check and
tighten any loose hardware and
repeat again every six months
thereafter.

IT IS THE USER'S RESPONSIBILITY TO MAINTAIN THE FURNITURE. THE HARDWARE MAY LOOSEN OVER TIME AND MAY CAUSE THE FURNITURE TO BE WOBBLY AND UNABLE TO SUPPORT ITS INTENDED WEIGHT CAPACITY. THIS MAY LEAD TO COLLAPSE AND MAY CAUSE SERIOUS INJURY.

TABLE

CM3609PT-5PK

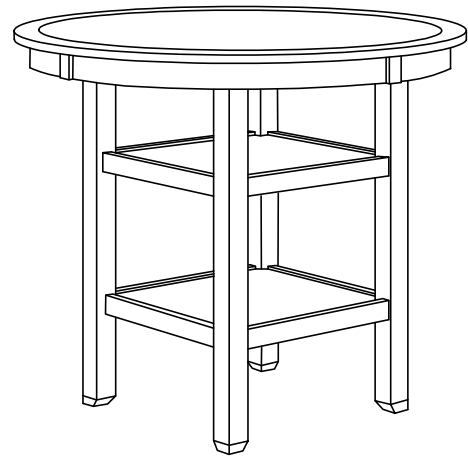
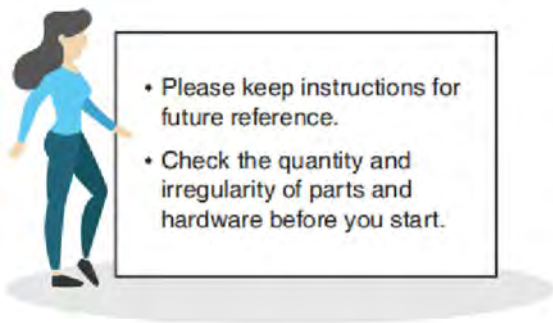

PARTS

#1 1pc

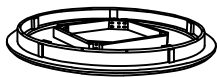

Table Top

#2 4pcs

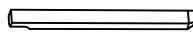

Table Leg

#3 2pcs

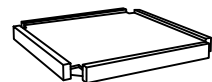

Table Shelve

HARDWARE

#A 12pcs



Bolt Ø5/16" x 2-3/8"

#B 12pcs



Lock Washer Ø5/16"

#C 12pcs



Flat Washer Ø5/16"

#D 1pc

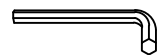

Allen Wrench 4mm

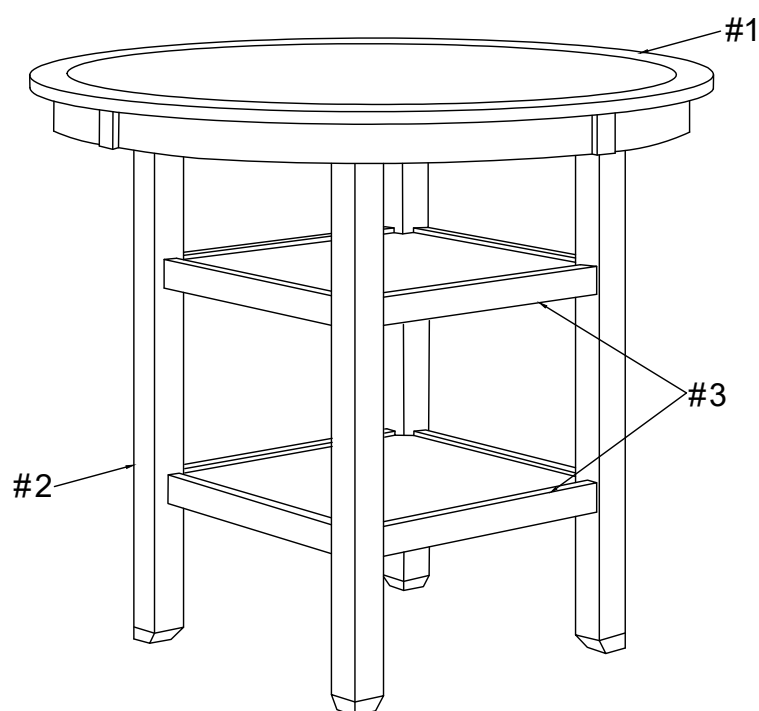

ASSEMBLY INSTRUCTIONS

1

Part #2 x2pcs
Part #3 x2pcs
Hardware #A x4pcs
Hardware #B x4pcs
Hardware #C x4pcs

Align shelves (#3) to legs (#2), then secure by using bolts (#A) with washers (#B,C).

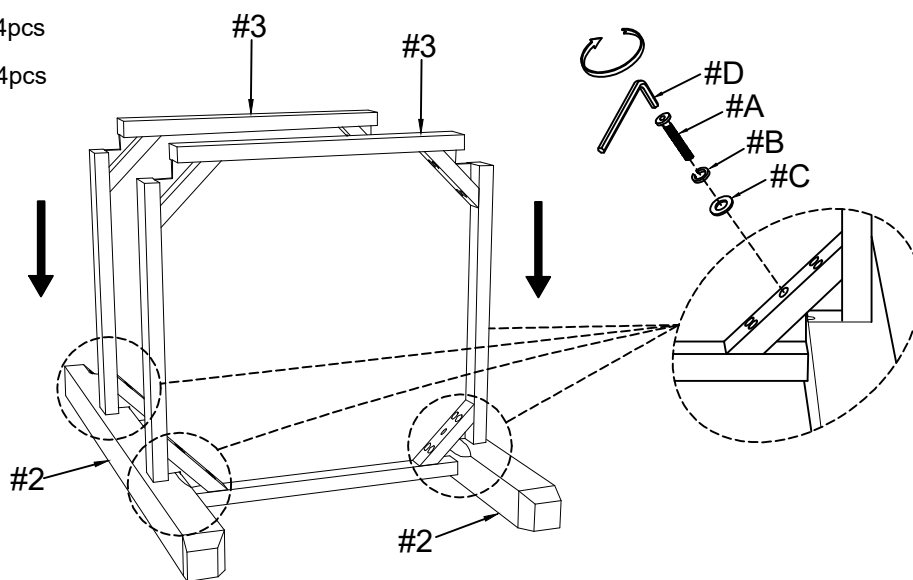

2

Part #2 x2pcs
Hardware #A x4pcs
Hardware #B x4pcs
Hardware #C x4pcs

Align legs (#2) to shelves (#3), then secure by using bolts (#A) with washers (#B,C).

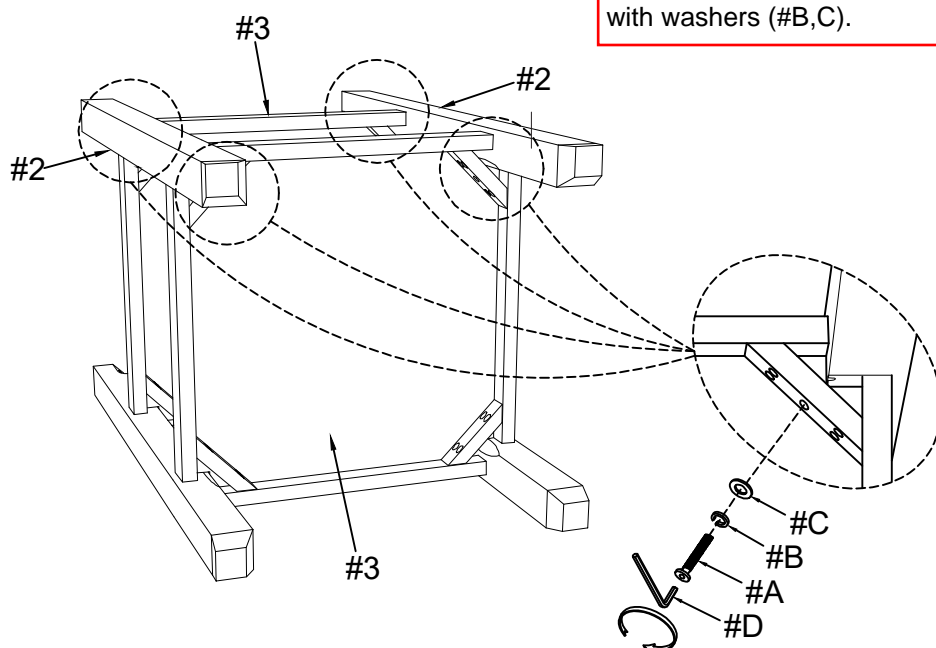

ASSEMBLY INSTRUCTIONS

3

Part #1 x1pc
Hardware #A x4pcs
Hardware #B x4pcs
Hardware #C x4pcs

Align table top (#1) to legs (#2), then secure by using bolts (#A) with washers (#B,C).

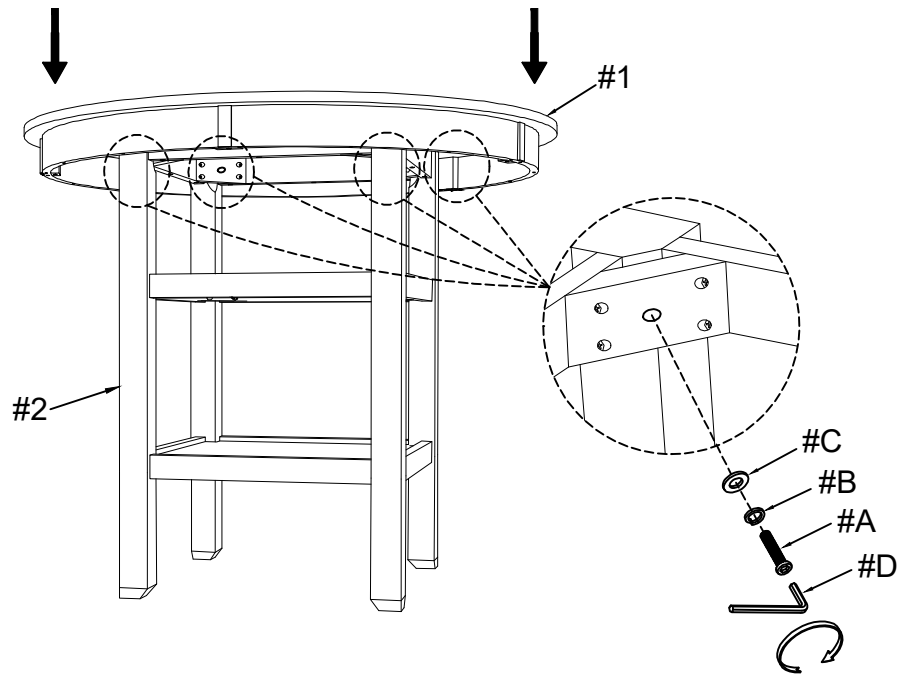

4

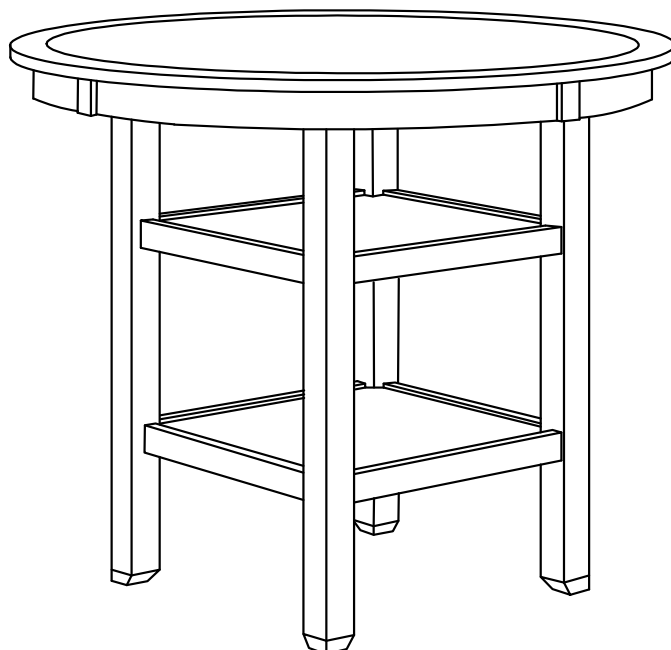

CHAIR

CM3609PT-5PK

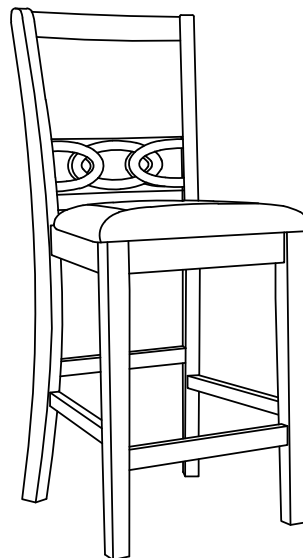
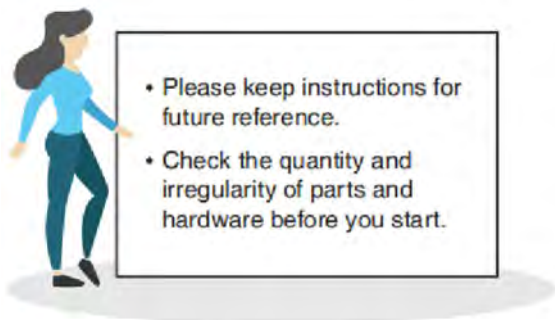

PARTS

#1 1pc x4



Chair Back

#2 1pc x4

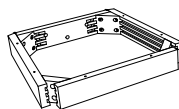

Seat Frame

#3 1pc x4



Cushion Seat

#4 2pcs x4

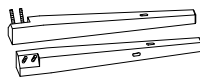

Front Legs (L&R)

#5 2pcs x4



Side Stretcher (L&R)

#6 1pc x4



Front Stretcher

HARDWARE

#A 4pcs x4



Bolt Ø1/4" x 3"

#B 3pcs x4



Bolt Ø1/4" x 1-1/4"

#C 11pcs x4



Lock Washer Ø5/16"

#D 11pcs x4



Flat Washer Ø5/16"

#E 4pcs x4



Nut Ø5/16"

#F 1pc

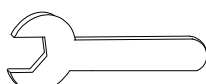

Wrench 13mm

#G 12pcs x4



Screw #8 x 38mm

Exploded View

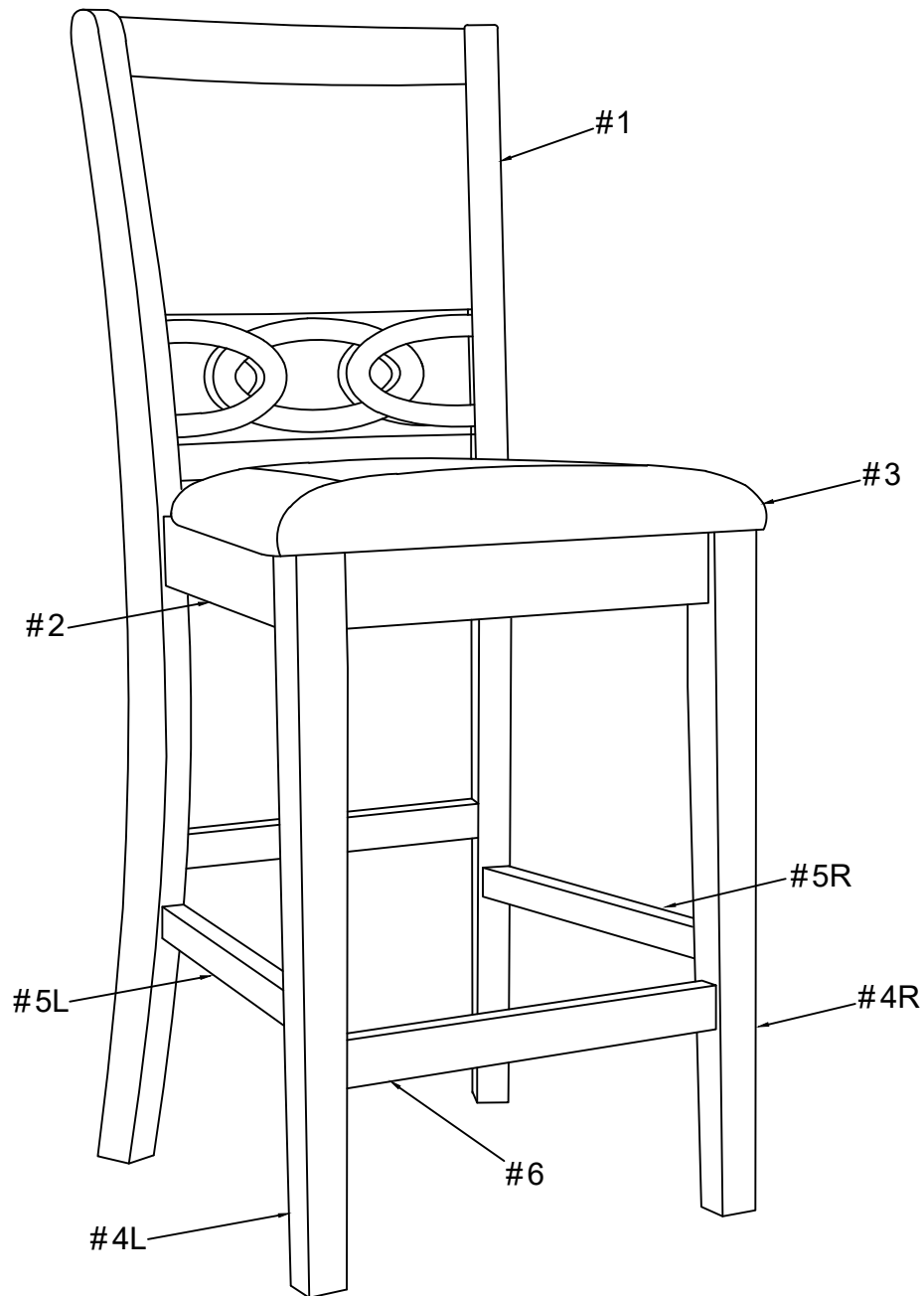

x 4

ASSEMBLY INSTRUCTIONS

1

Part **#1** x1pc
Part **#2** x1pc
Hardware **#B** x3pcs
Hardware **#C** x3pcs
Hardware **#D** x3pcs

Align seat frame (**#2**) to chair back (**#1**), then secure by using bolts (**#B**) with washers (**#C,D**).

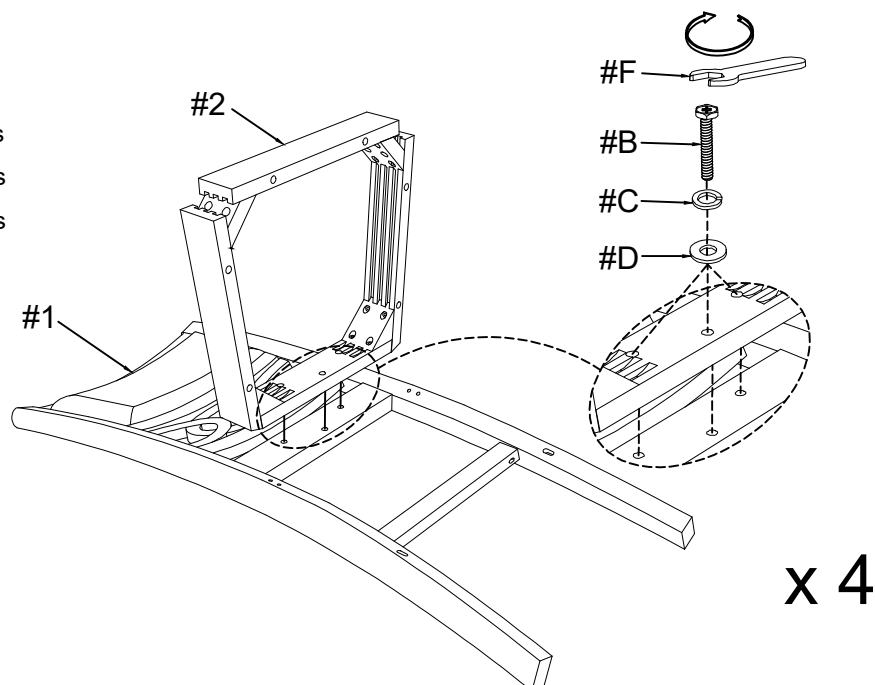

2

Hardware **#A** x4pcs
Hardware **#C** x4pcs
Hardware **#D** x4pcs

Secure corner holes of the seat frame (**#2**) to chair back (**#1**) by using bolts (**#A**) with washers (**#C,D**).

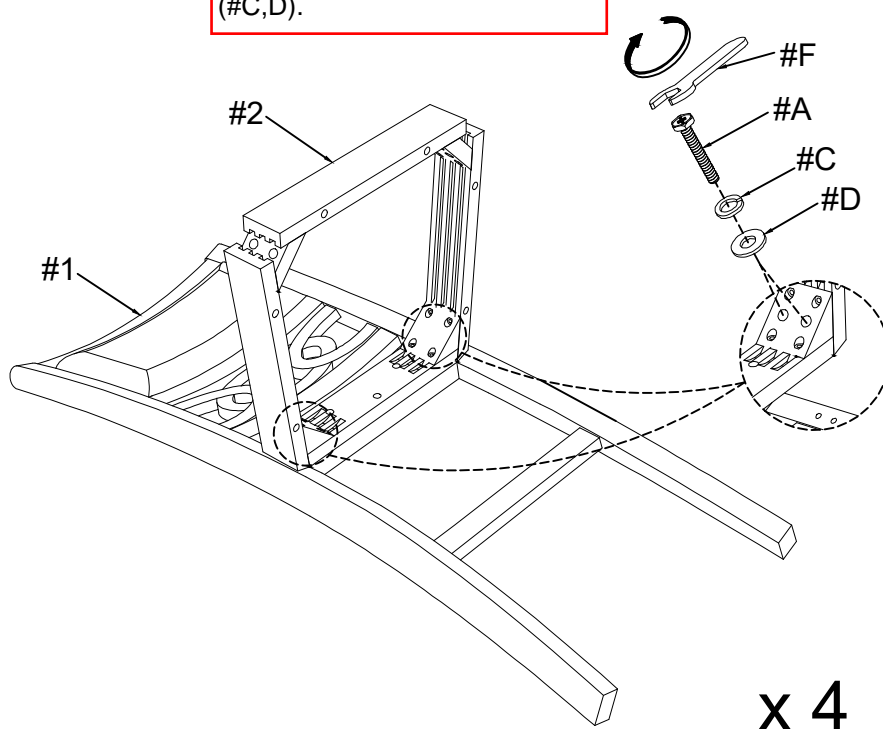

ASSEMBLY INSTRUCTIONS

3

Part **#5** x2pcs
Hardware **#G** x2pcs

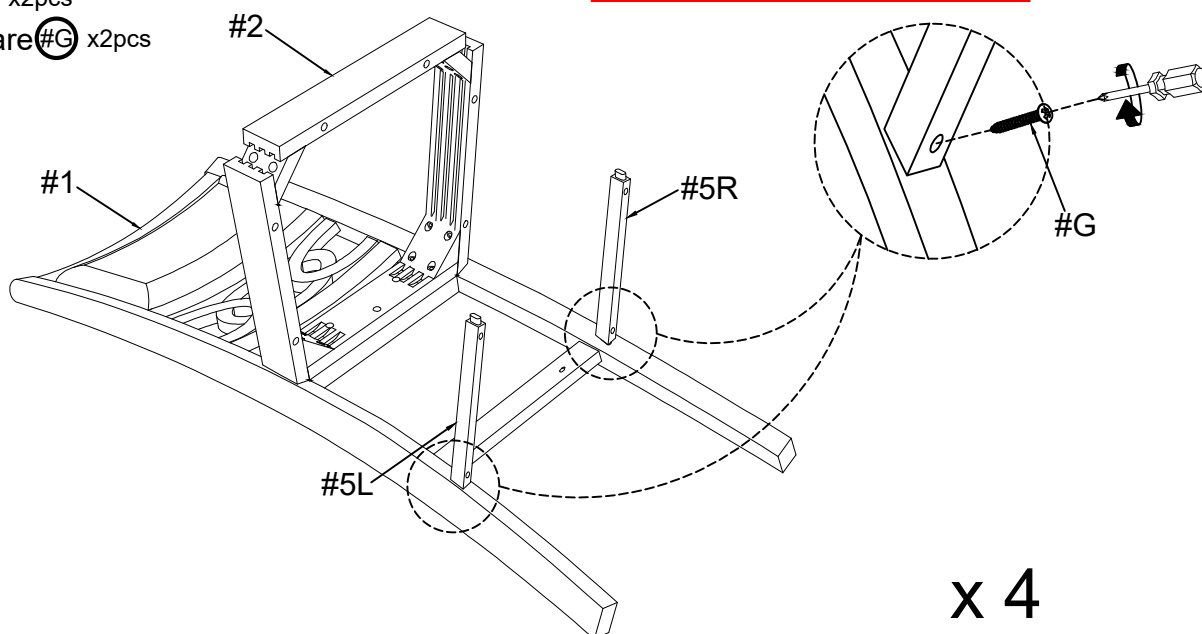

4

Part **#4** x2pcs
Part **#6** x1pc
Hardware **#C** x4pcs
Hardware **#D** x4pcs
Hardware **#E** x4pcs

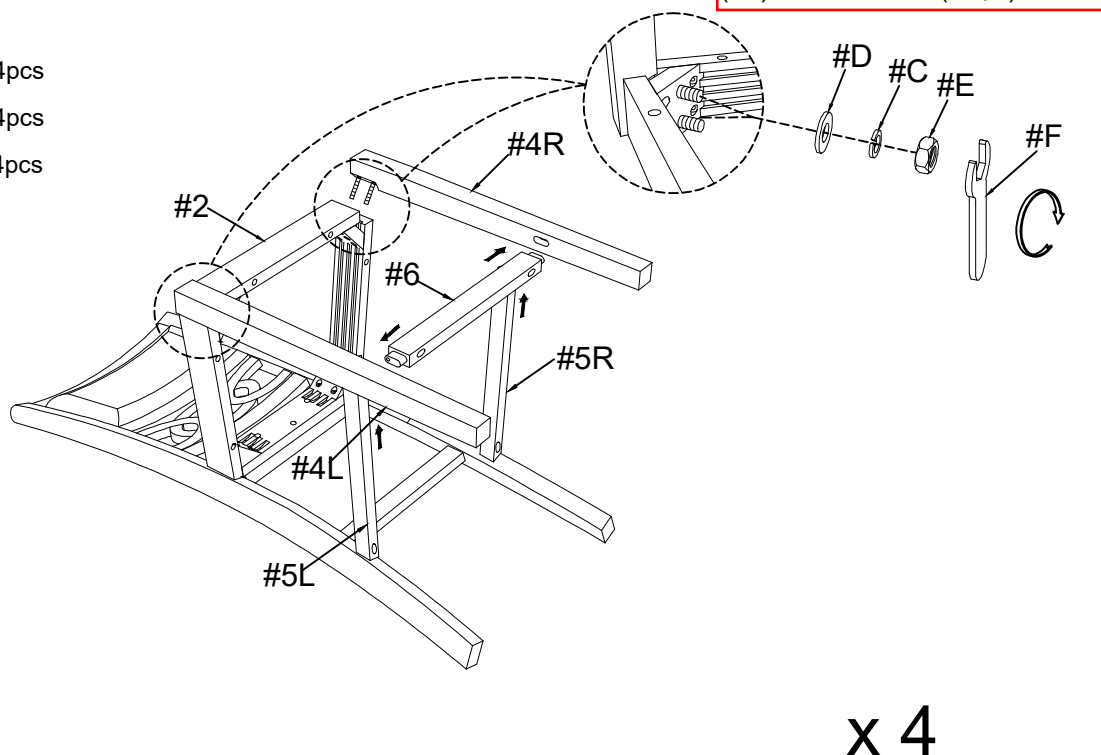

ASSEMBLY INSTRUCTIONS



5

Hardware  x4pcs

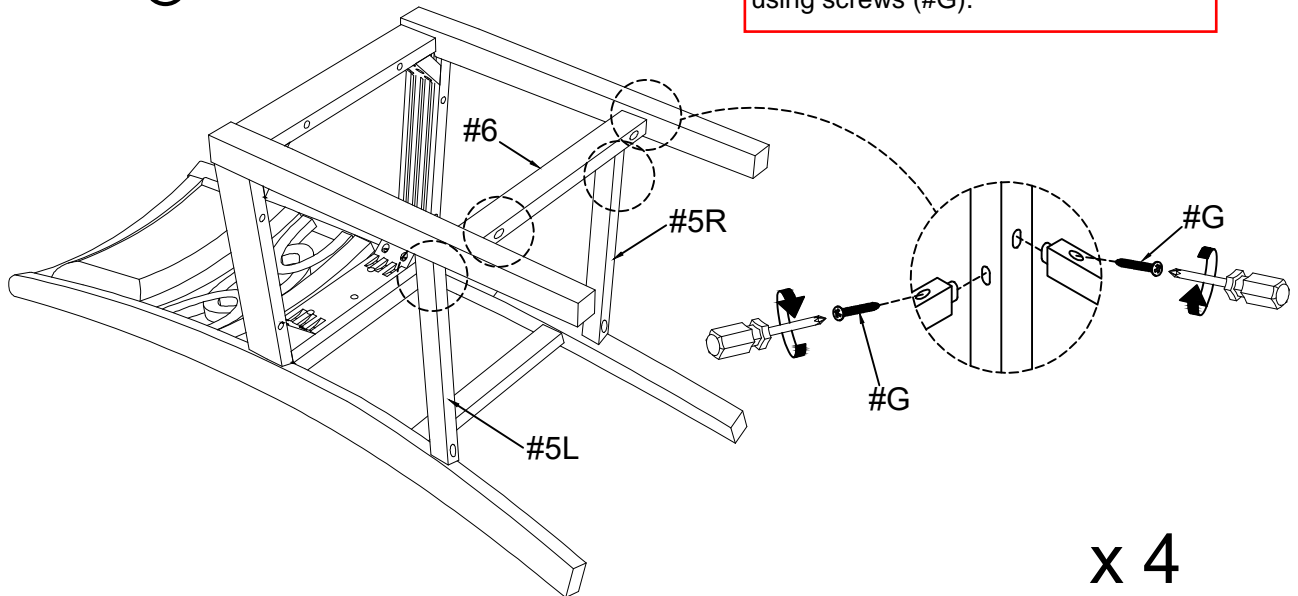
Secure stretchers (#5R/L,6) to legs by using screws (#G).



6

Part  x1pc
Hardware  x6pcs

Align seat (#3) to seat frame (#2), then secure by using screws (#G). There are no pre-drilled holes for this step.

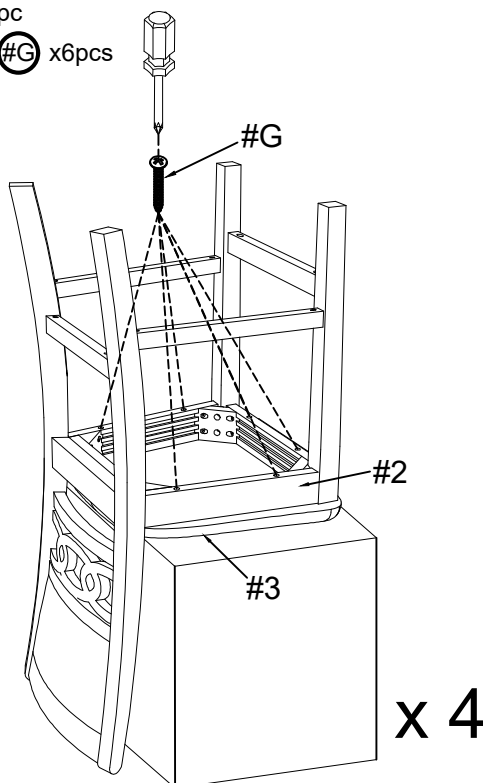

ASSEMBLY COMPLETED



Please ensure the furniture rests on an even and flat surface. If the product wobbles or feels loose, double-check all bolts and/or screws are properly tightened and secured.



Keep this handy!

Please retain this instruction manual and any order-related information for future reference.



Lift, don't drag!

To avoid damage to product please always LIFT the product when transporting or adjusting the placement.