



Furniture of America®

ASSEMBLY INSTRUCTIONS

MODEL #

CM-DK6846

Questions?

GIVE US A CALL: 1-888-980-5122
MON-FRI 8:30AM - 5:30PM (PT)

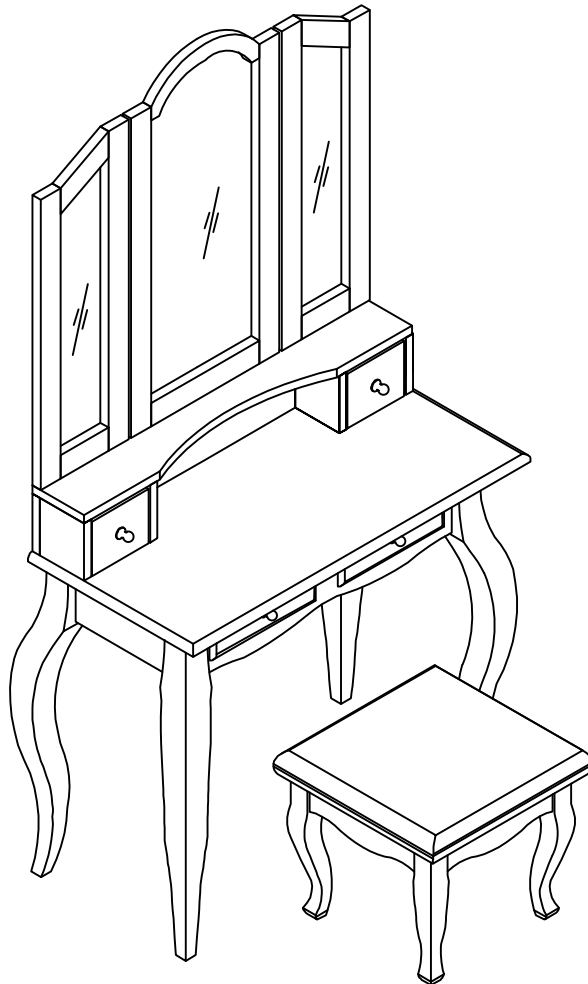

TOOLS REQUIRED



Allen Wrench

(Included)



Phillips
Screwdriver

(Not Included)



2 - People
Recommended

ASSEMBLY RATING



EASY → DIFFICULT

The Assembly Rating is a 5-point system showing the level of effort needed to assemble a specific product.



FOA Intro

Thank you for your purchase!

We hope you enjoy this new addition to your home for many years to come.

Our commitment to providing quality products does not simply end when you purchase our product. We fully stand behind our products from start to finish. Our customer service department is available Monday – Friday 8:30 AM – 5:30 PM Pacific Time and can help with assembly questions as well as, if necessary, replacing damaged or missing parts. To help expedite our service, please have these assembly instructions readily available, along with your order receipt.

 **Consumer Hotline**
Toll-Free 1-888-980-5122

 **Monday to Friday**
8:30AM- 5:30PM (PT)

 **WEBSITE**
www.foagroup.com

 **E-MAIL**
cs.ec@foagroup.com

    foagroup

 FurnitureOfAmerica

CHECK BEFORE STARTING

Are you missing anything?
Double-check all parts, hardware and accessories listed are all accounted for.

Check out our Quick Tips!
We recommend reviewing the pre-assembly handouts. Even experts need a refresher now and then!

Should we send any replacements?
Are there any irregularities or flaws in the parts? We can send replacements!

Prep Time!
Please review the assembly instructions and all diagrams prior to assembling.

PRE ASSEMBLY INTRODUCTION

We understand building ready-to-assemble furniture can be a challenging experience for some. To help avoid confusion, we have provided some helpful tips that may speed up the process.



Teamwork

ALWAYS have at least two people to help with transporting and assembling the product to avoid potential injury and/or damage.



Suitable Location

Assembling near the area of the intended location is highly recommended.



Sufficient Space

Make sure you have enough space to move around during the assembly.



Avoid Scratches

Use cardboard, blankets or a carpeted area while assembling furniture to prevent to prevent scratches and damages.



Flat Surface

Make sure the furniture rests on a flat and level surface with each leg evenly touching the floor.

ASSEMBLY AND CARE ADVICE



FAILURE TO FOLLOW THE GUIDELINES BELOW MAY RESULT IN INJURY AND/OR PROPERTY DAMAGE.



Position each part correctly and insert screws or bolts into their respective holes.

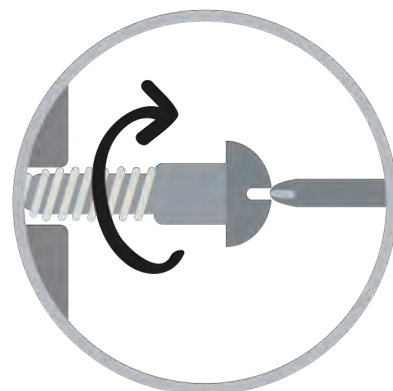

Turn clockwise to tighten and only tighten when step is completed or when instructed to do so.



Use the appropriate hand tools or power tools for assembly. Select steps, such as tightening screws and/or bolts, may require hand tools to avoid causing damage during assembly.



Save the instructions and store any supplied tools for later maintenance.

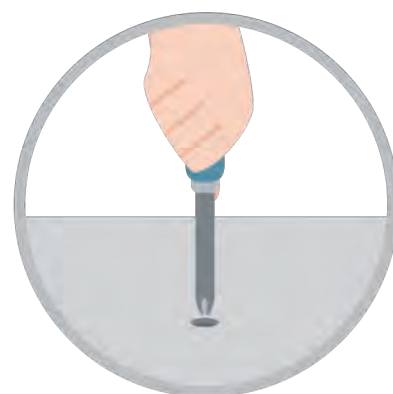

After two weeks, check and tighten any loose hardware and repeat again every six months thereafter.

IT IS THE USER'S RESPONSIBILITY TO MAINTAIN THE FURNITURE. THE HARDWARE MAY LOOSEN OVER TIME AND MAY CAUSE THE FURNITURE TO BE WOBBLY AND UNABLE TO SUPPORT ITS INTENDED WEIGHT CAPACITY. THIS MAY LEAD TO COLLAPSE AND MAY CAUSE SERIOUS INJURY.

VANITY SET

CM-DK6846

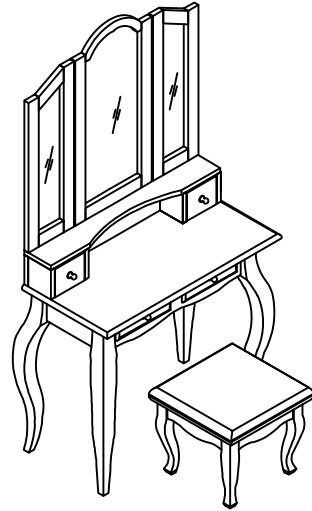
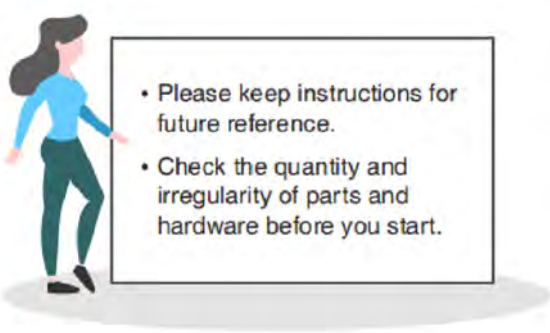

PARTS

#1 1pc

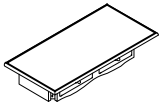

Cabinet Body

#2 4pcs



Table Leg

#3 1pc



Hutch Top

#4 4pcs

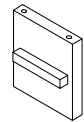

Hutch panel

#5 1pc

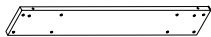

Hutch Back

#6 2pcs



Drawer

#7 2pcs



Mirror Support

#8 1pc



Middle Mirror

#9 2pcs



Mirror (L&R)

#10 1pc

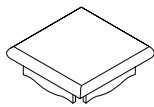

Stool Seat

#11 4pcs



Stool Leg

HARDWARE

#A 20pcs



Bolt $\text{\O}1/4'' \times 2''$

#B 24pcs



Washer $\text{\O}5/16'' \times 19\text{mm}$

#C 24pcs



Lock washer $\text{\O}1/4''$

HARDWARE

#D 1pc



Allen Wrench 4mm

#E 4pcs



Barrel Nuts Ø1/4"

#F 8pcs



Bolt Ø1/4" x 1-3/8"

#G 1set



Anti-tip Skit

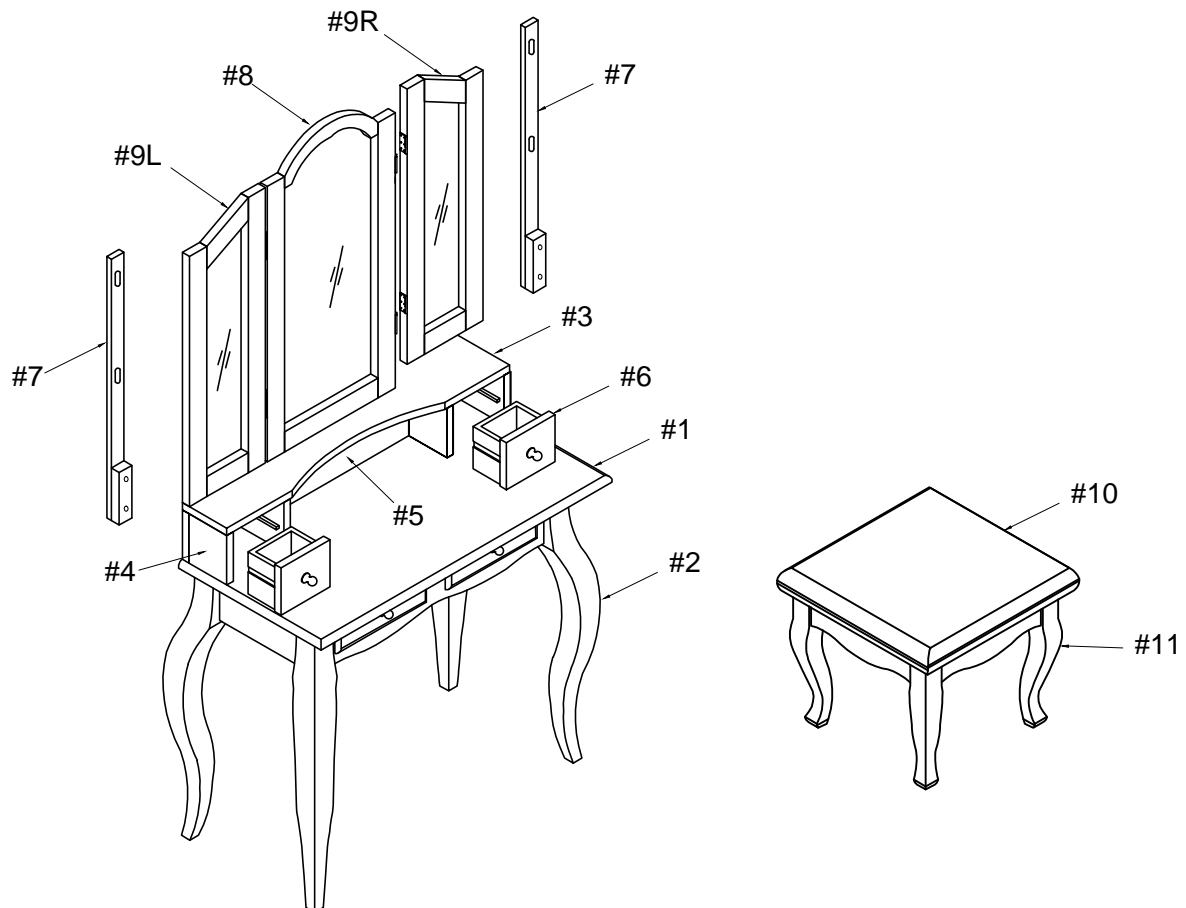

ASSEMBLY INSTRUCTIONS

1

- Part #1 x1pc
- Part #2 x4pcs
- Hardware #A x8pcs
- Hardware #B x8pcs
- Hardware #C x8pcs

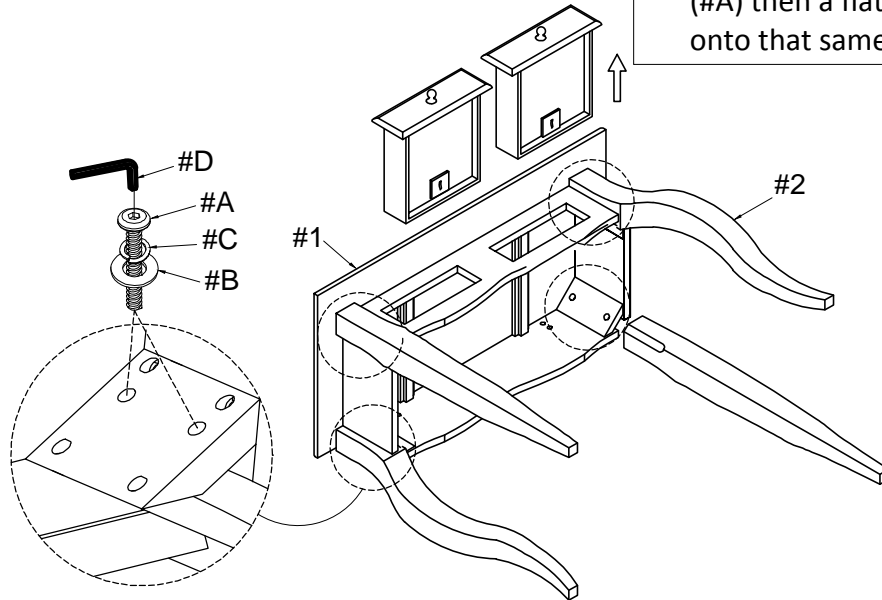

1. Prepare 8 bolt assemblies by first inserting a lock washer (#C) onto the bolt (#A) then a flat washer (#B) onto that same bolt (#A)

2. Align the legs (#2) to the corners along the cabinet body (#1), then insert the bolt assemblies from within and secure.

2

- Part #3 x1pc
- Part #4 x4pcs
- Part #5 x1pc
- Hardware #A x2pcs
- Hardware #E x2pcs

2. Align the hutch top (#3), then insert the bolts (#A) into the holes and secure using the Allen wrench (#D).

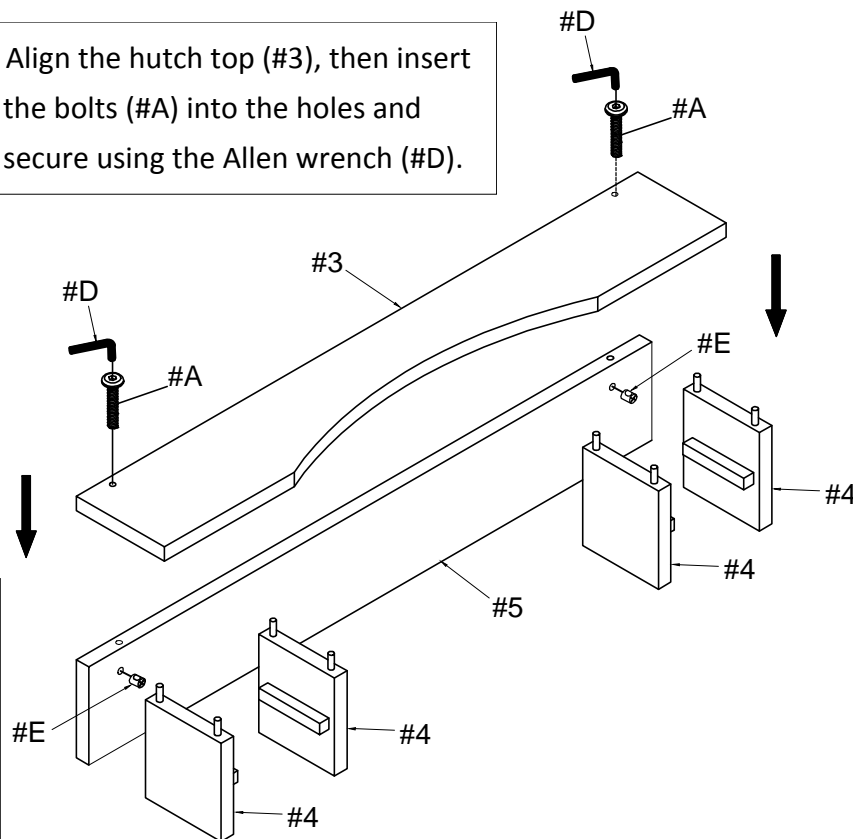

1. Insert the barrel nuts (#E) into the large holes. Make sure the openings face the holes.

ASSEMBLY INSTRUCTIONS

3

Insert into the holes along the cabinet body (#1).

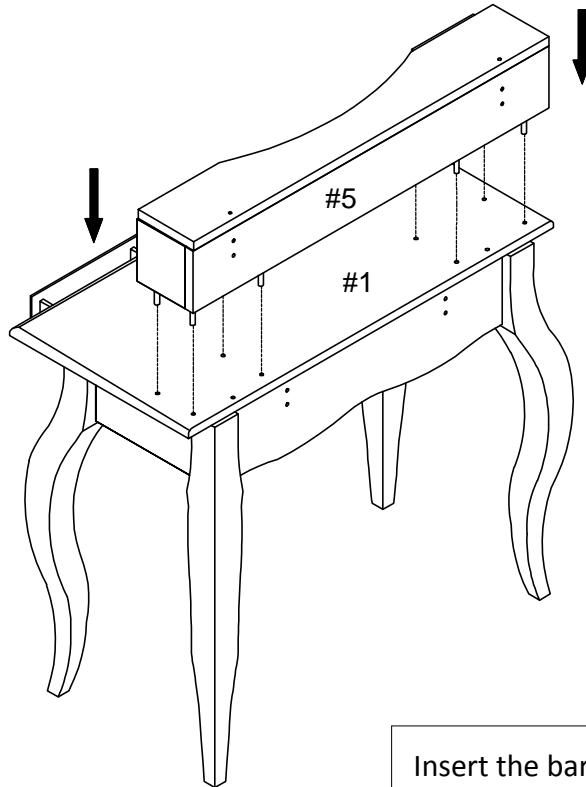

Insert the barrel nuts (#E) into the large holes with the openings facing the hole, then insert the bolts (#A) from beneath. Secure using the Allen wrench (#D).

4

Hardware #A x2pcs
Hardware #E x2pcs

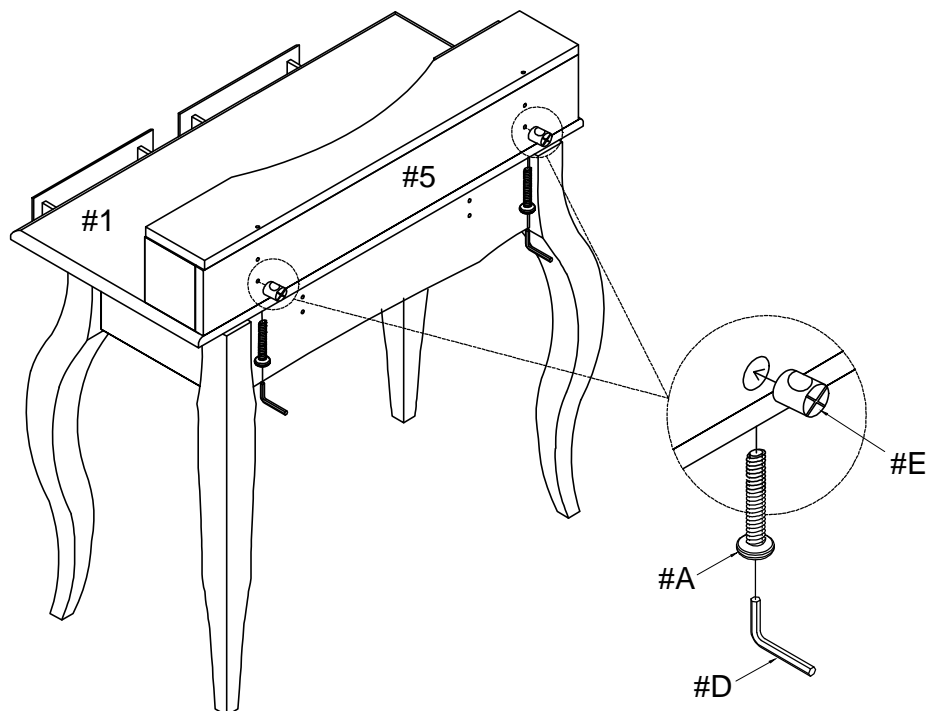

ASSEMBLY INSTRUCTIONS

5

1. Align the mirror supports (#7) to the holes along the back.

Part #7 x2pcs

Hardware #B x4pcs

Hardware #C x4pcs

Hardware #F x4pcs

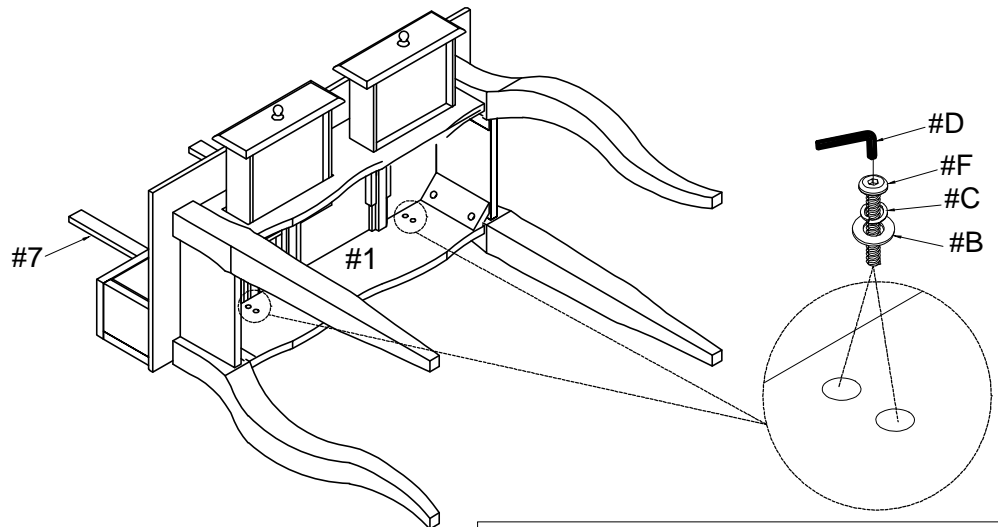

2. Prepare 4 bolt assemblies by first inserting a lock washer (#C) onto the bolt (#F) then a flat washer (#B) onto that same bolt (#F). Insert a bolt assembly into each hole and secure

6

Part #8 x1pc

Hardware #B x4pcs

Hardware #C x4pcs

Hardware #F x4pcs

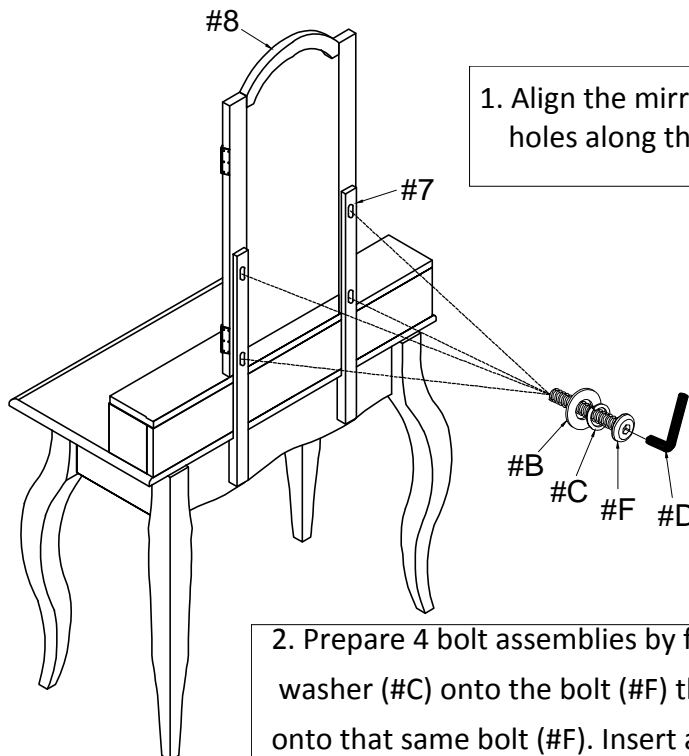

1. Align the mirror (#8) to the holes along the supports.

2. Prepare 4 bolt assemblies by first inserting a lock washer (#C) onto the bolt (#F) then a flat washer (#B) onto that same bolt (#F). Insert a bolt assembly into each hole and secure

ASSEMBLY INSTRUCTIONS

7

Part #6 x2pcs
Part #9 x2pcs(L.R)

Insert the brackets along the left and right mirrors (#9) into the pins along mirror (#8).

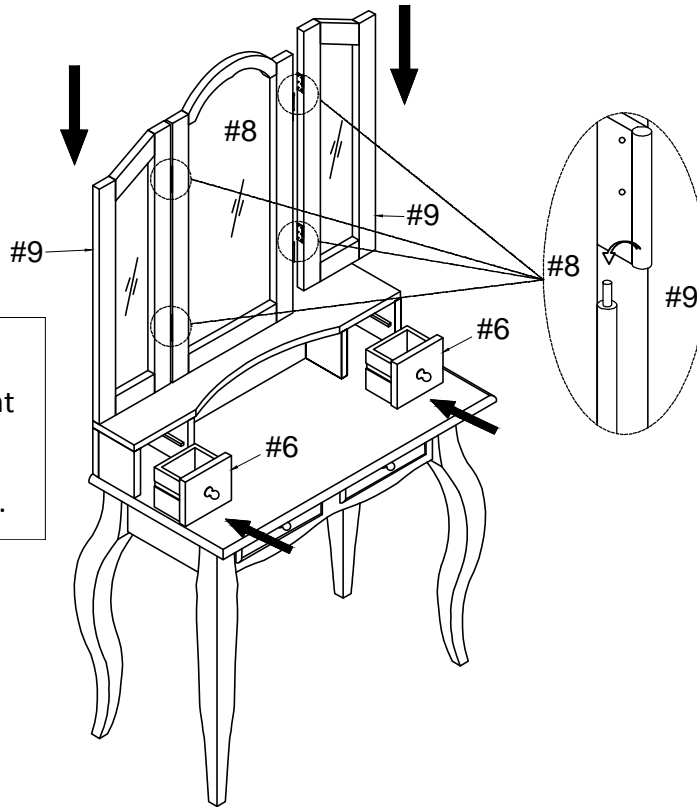

8

Hardware #G x1SET

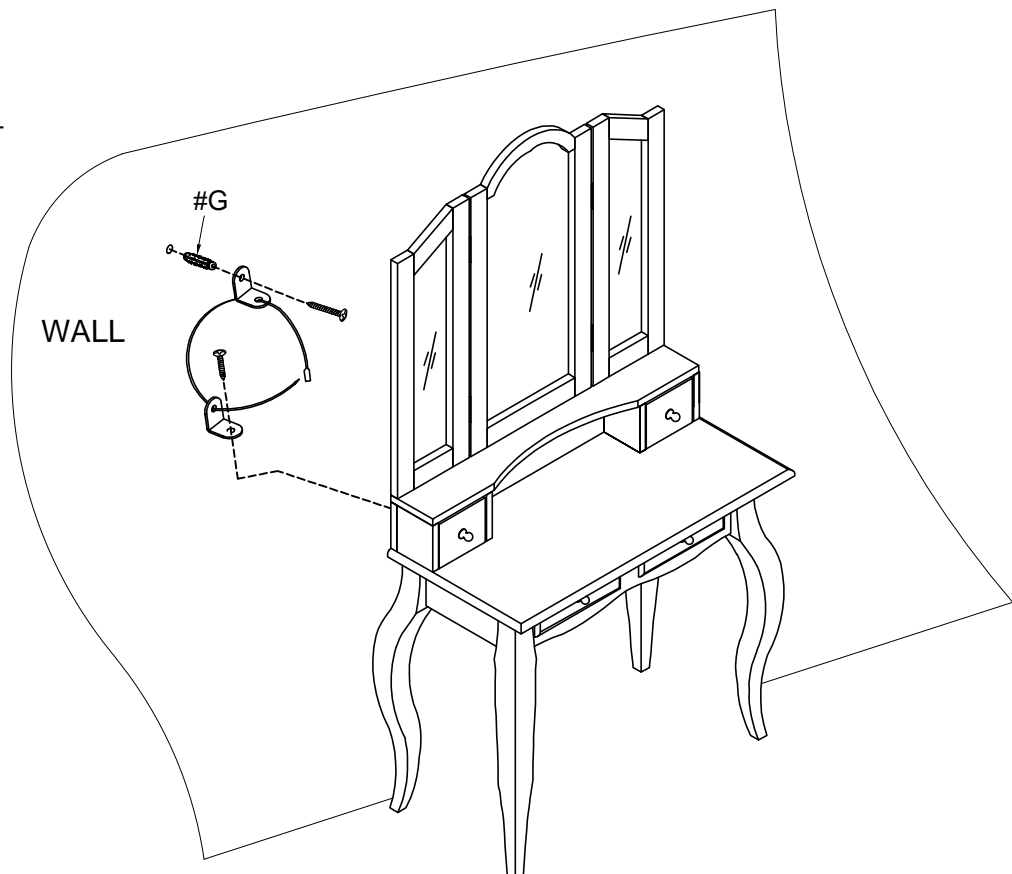

ASSEMBLY INSTRUCTIONS

9

Part #10 x1pc

Part #11 x4pcs

Hardware #A x8pcs

Hardware #B x8pcs

Hardware #C x8pcs

1. Prepare 8 bolt assemblies by first inserting a lock washer (#C) onto the bolt (#A) then a flat washer (#B) onto that same bolt (#A).

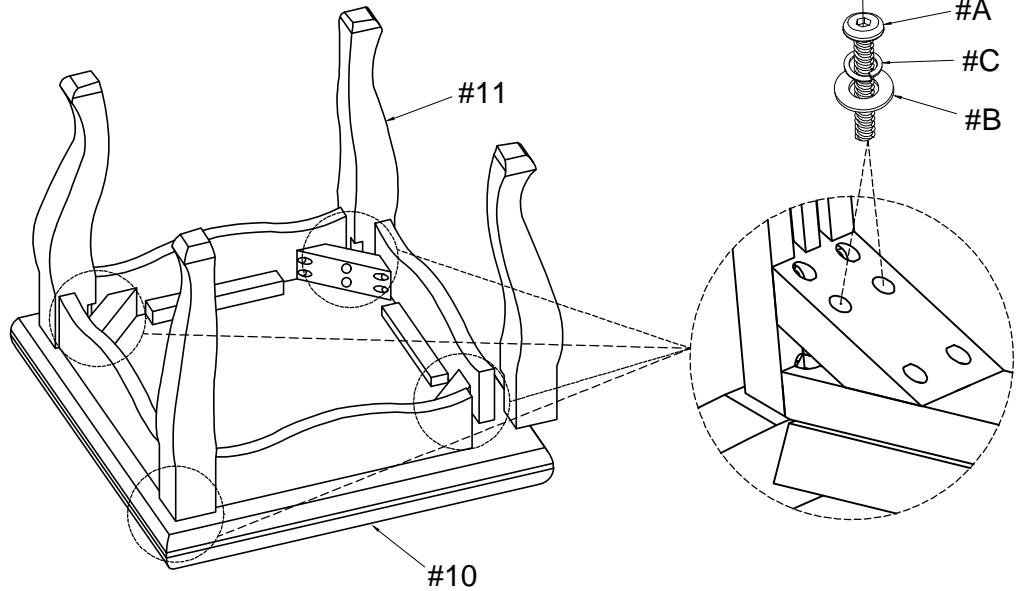

2. Align the legs (#11), then insert the bolt assemblies from within and secure.

10

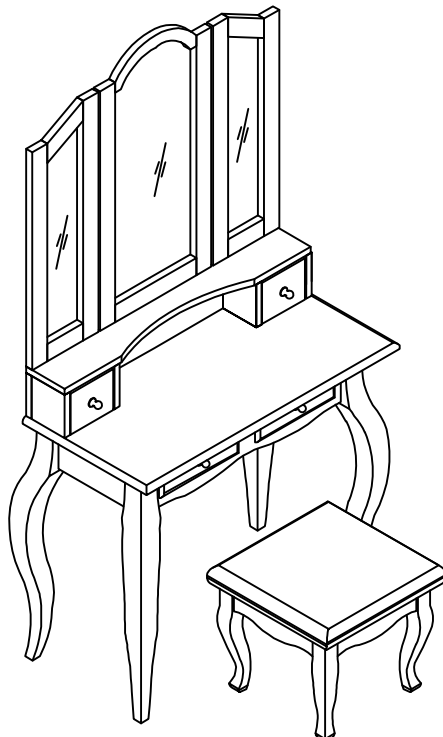

ASSEMBLY COMPLETED



Please ensure the furniture rests on an even and flat surface. If the product wobbles or feels loose, double-check all bolts and/or screws are properly tightened and secured.

✓ **Keep this handy!**

Please retain this instruction manual and any order-related information for future reference.

✓ **Lift, don't drag!**

To avoid damage to product please always LIFT the product when transporting or adjusting the placement.

ASSEMBLY INSTRUCTIONS

Wall Mounting and Fixing



EXPANSION WALL ANCHOR

Our provided expansion wall anchors are only suitable for masonry walls, such as drywall, plaster or concrete, and are best for holding lightweight items or for anti-tip prevention. If you are unsure of the correct wall anchor to use with the product, please request professional guidance. Liability for product damage or failure due to using the incorrect anchors will fall on the installer.

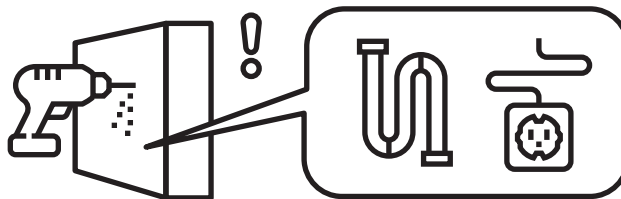

CHECK BEFORE PROCEEDING

Prior to drilling or hammering, please check for wires or pipes. We recommend using a stud finder to locate a stud, which will offer more appropriate resistance and hold more weight.

QUICK TIPS

1. If unsure of the proper size, always choose a larger screw and wall anchor.

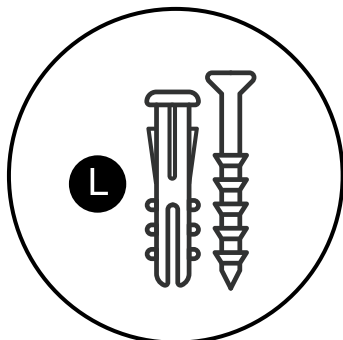

2. Match the drill bit to the wall anchor and hole size.

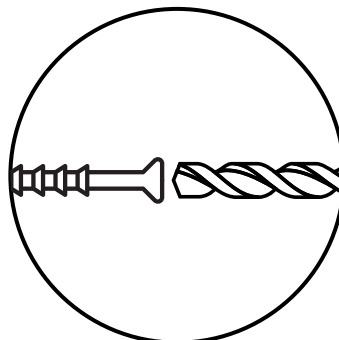

3. Only drill horizontally. Do not force the drill or enlarge the hole for the wall anchor.

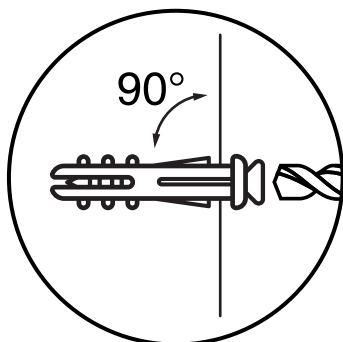

4. Take extra care when drilling into high walls or ceramic tiles. Wall anchors should be a tight fit for the hole. Never use wall anchors in ceilings.

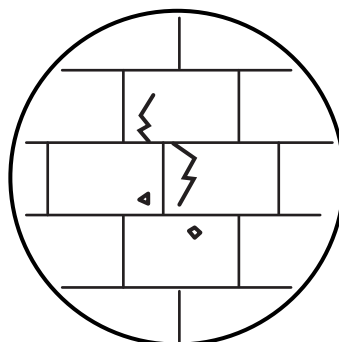

MAINTENANCE



We recommend a yearly check to see if the wall anchor or screw has loosened. If so, please remove the existing wall anchor and screw, and use a new anchor.