

UMA

—By Lledo & Campos—



■ **DESCRIPTION**

Seat and back have an aluminium internal frame covered by 90-100 m³ density flexible **PUR injected foam**. This foam is additionally covered by a foam fabric made of 3mm PU foam (22kg/m³ density) + Fabric. The back of the chair is 30mm thick and seat is 40mm thick. Available with or without arms. Upholstered arms with internal aluminium frame covered by injected foam. **Beech conical wooden legs**. PP glides with black anti-slip filter.

■ **BACK AND SEAT**

(SEE FINISHES AND FABRIC CARD LAST PAGE)

■ **ARMS OPTIONS**



Upholstered arm with internal structure [20 x 6 mm + calibration plate Ø 8 mm] injected foam coated steel

■ **SIZES**

Total height: 870 mm
Total width: 520 mm
Total depth: 530 mm

Seat Height: 440 mm
Seat Width: 450 mm
Seat Depth: 430 mm

■ **SIZES**

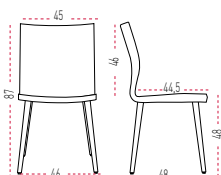

without arms

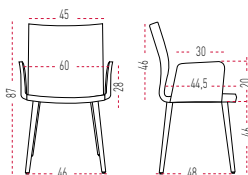

upholstered arms

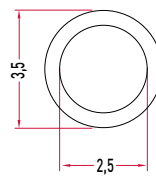

- ① PU flexible de 90 - 100 kg/m³ back and seat
- ② Model without arms or with upholstered arms
- ③ Conical wooden leg. Beech finishing
- ④ PP glides in black with anti-slip filter.
- ⑤ The upholstery incorporates hot sealed markings, which provides uniqueness *(Only on M and A fabrics)*



MATERIALS

Maximum use of materials to eliminate and minimize scraps. Use of recyclable and recycled materials in those components that do not affect the functionality and durability.

10,41%
RECYCLED
MATERIALS



PRODUCTION

Maximum optimization of energy use. Minimal environmental impact. Last generation technological systems. Zero discharge of wastewater. No VOC coatings. Processes free of heavy metals, phosphates, OC and COD.

100%
RECYCLABLE
ALUMINIUM, STEEL
& WOOD



TRANSPORT

Detachable systems. Volumes that facilitate the optimization of space. Maximum reduction of energy consumption by transport.

100%
RECYCLABLE
PACKAGE AND THINNER
FREE



USE

Quality and warranty. Long lasting. Replacements available.

EASY
TO CLEAN
AND MAINTAIN



DISPOSAL

Waste reduction. Supplier-manufacturer packaging reuse system. Components are easy to be separated. Inks in packaging are water-based, without solvents.

78,55%
RECYCLABLE
MATERIALS

■ **CERTIFICATES AND REFERENCES**

The different programmes get points in different environmental categories to get the LEED certificate (sustainability, material and resources, water, energy and atmosphere, inner environment quality, innovation and design).



■ **STANDARDS**

UMA has passed tests done in our technical department as well as the tests done in **AIDIMA** the Technological Institute for furniture. The tests correspond to:

Office visitor chair. Standard Application

- **UNE-EN 16139:13.** Furniture. Resistance, long lasting, security. Requirements for non domestic use seating.